

# Full Line GENERATORS

 **SUBARU**  
Industrial Power Products









# A superior product. Service. Support.

## A name you can trust. It all adds up to Subaru.



No matter the reason, regardless of the location, you count on your generator to deliver power on demand. Featuring industry-leading technology, state-of-the-art components, and engines that start with ease every time, Subaru generators offer a superior level of reliability and performance.

Our complete line of generators, including industrial, commercial, and silent inverter, range in wattage output from 2,900 to 13,000. From home to recreation, construction to industrial, Subaru has you covered with the proper generator for any application. And every gas-powered generator features a powerful Subaru engine, providing you with a complete, integrated unit and solid warranty covering the entire machine.

## Powered By Subaru Engines



### Insist on the Subaru performance package:

- Less recoil pulling force, an electronic ignition system and automatic decompression means easy starting every time and at every temperature.
- High power and torque, extended running times and high compression ratio ensure maximum power and premium performance in the most demanding applications.
- Cast-iron cylinder liners, high carbon steel crankshaft, steel ball bearings and electronic low oil shut-off maximize engine life with minimum maintenance.
- More than 5,000 service dealers in North America, and the most coveted five-year warranty in the industry.

**Reliability. Dependability. Serviceability. It all adds up to Subaru.**

# Generators Inverter



By combining durability, power and exceptional quality with state-of-the-art inverter technology, Subaru ensures a hard-working generator that's as quiet as a whisper. Whether it's commercial or residential use, you'll see our inverter generators are quietly taking the market by storm.

## Power and Performance

### Efficient Power Creation

While conventional generators produce one AC sine wave per engine rotation, Subaru inverter generators create more than 300 AC sine waves per rotation. More electrical power is produced by Subaru inverter generators from each engine rotation.

However, the power produced must first be changed to the form needed to power electrical appliances. This conversion is performed in two steps within the Subaru inverter module. First, the electrical power is converted to DC power. Then the DC power is inverted by the electronics of the inverter module to output very clean 120-volt, 60-hertz AC power.

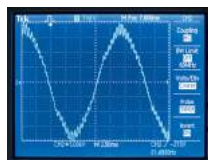

Typical generator  
sine wave

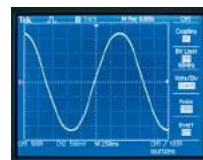

Inverter generator  
sine wave

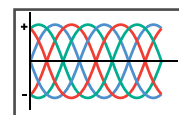

#### Step 1

Produce three-phase  
AC power at up to  
20,000 hertz

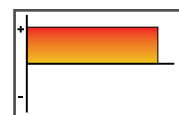

#### Step 2

Convert AC power  
to DC power

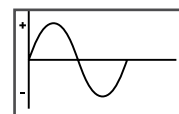

#### Step 3

Convert DC power  
to clean AC power  
at 120 volts/60 hertz

### Why Inverter?

Inverter generators are unlike any other. These units produce power in a different manner – the end result is often referred to as “clean power”. This type of power is stable and free of potentially harmful voltage surges.

50 State Tier 3 compliant.

# 3200-4300W

S3200i | S4300i



## Features & Benefits

- ① Large Capacity Fuel Tank with Fuel Gauge**  
Provides extended run time between refueling and monitors current fuel level.
- ② Multi-Monitor Display and Auto-Power System**  
Tracks and displays crucial data, while the system adjusts engine speed to meet power requirements for optimal operation.
- ③ Single-Dial Control**  
Allows operator to start and run the generator, as well as turn off the fuel valve with one easy-to-use dial.
- ④ Sound Attenuating Resin Panels With Foam Lining**  
Ensure quiet operation.
- ⑤ Full Tubular Steel Frame with Four-Wheel Kit**  
Protects generator, engine and components from damage, while enhancing portability (S3200i and S4300i).
- ⑥ Extra-Large Muffler**  
Ensures quiet operation and features U.S. Forestry-approved spark arrestor to reduce risk of spark-induced fires.
- ⑦ GFCI Duplex and Twist Lock Receptacles**  
Enhance operator safety – S3200i and S4300i include one Twist Lock receptacle.
- ⑧ Inverter Module**  
Provides clean and stable power for sensitive electronic equipment.





# Generators Industrial



Designed for the demands of construction and industrial use, Subaru's line of industrial generators features rugged, reliable construction. Though not as quiet as our inverter generators, these workhorses include top-of-the-line components to reduce noise. Exceptional performance in any application. It's easy to see why Subaru's industrial generators are the choice for the most discerning customers.

## Power and Performance

### Automatic Voltage Regulator

An Automatic Voltage Regulator (AVR) system allows finer voltage control for steady output and less fluctuations. The system uses electronics to continuously monitor voltage output and provide the accurate control necessary to power more sensitive equipment. The AVR system can be found on Subaru SGX generators, larger industrial RGX generators and the RGV12100.



### Capacitor System

Subaru's capacitor system is designed to keep output voltage in balance, preventing both decrease in power and potentially harmful surges. If output voltage drops too low, power flows from the capacitor, increasing excitation. Conversely, if output voltage goes too high, the system stores excitation, causing voltage to drop until proper balance is met. The system allows output voltage as high as 150 percent over rated power for up to 20 seconds, allowing for increased motor starting performance. This feature can be found on Subaru's smaller RGX units – the RGX2900, RGX3600 and RGX4800 – as well as the diesel-powered RGD3300H generator.



### Why Industrial?

The answer is simple – these premium units have it all. Fully-loaded with professional-grade features and advanced technology, you won't find a more powerful, reliable generator than a Subaru Industrial model.

50 State Tier 3 compliant.



# 2900-13000W

RGX2900 | RGX3600 | RGX4800 | RGX6500 | RGX7500 | RGV12100 | RGV13100T



## Features & Benefits

- ① Large Capacity Fuel Tank with Fuel Gauge**  
Offers greater run time between refueling and displays current fuel level.
- ② Automatic Idle Control System**  
Lowers engine speed when power isn't required, increasing fuel efficiency and reducing noise.
- ③ Technologically-Advanced Overhead Cam (OHC) Engines and Electric Start**  
Provide easier starting, extended life and reduced noise emissions.
- ④ Full Tubular Steel Frame**  
Prevents damage to generator, engine and components.
- ⑤ GFCI and Twist Lock Receptacles**  
Ensure safe operation (Twist Lock receptacles not offered on RGX2900).
- ⑥ Solenoid Actuated AC Circuit Breakers**  
Protect generator from overload and offer maximum surge capacity.
- ⑦ Full-Power Switch**  
Allows the full 120-volt amperage of the generator to be drawn from the 120-volt receptacles.
- ⑧ Hour Meter**  
Tracks crucial maintenance intervals and monitors total hours of operation (Standard on most models).
- ⑨ High Surge Capacity**  
Allows for output as high as 150 percent over rated power for up to 20 seconds.



# Generators Commercial



Whether it's backup power for your home, a power source for a couple of tools or the need to power an entire worksite, you'll find a match for your needs in the Subaru SGX generator line. Best of all, the SGX generators are paired with Subaru's industry-leading, technologically-advanced engines, ensuring reliable power for the most demanding jobsites. If the unexpected happens, rest assured every Subaru generator is backed by our impressive 3-year generator warranty and 5-year engine warranty.

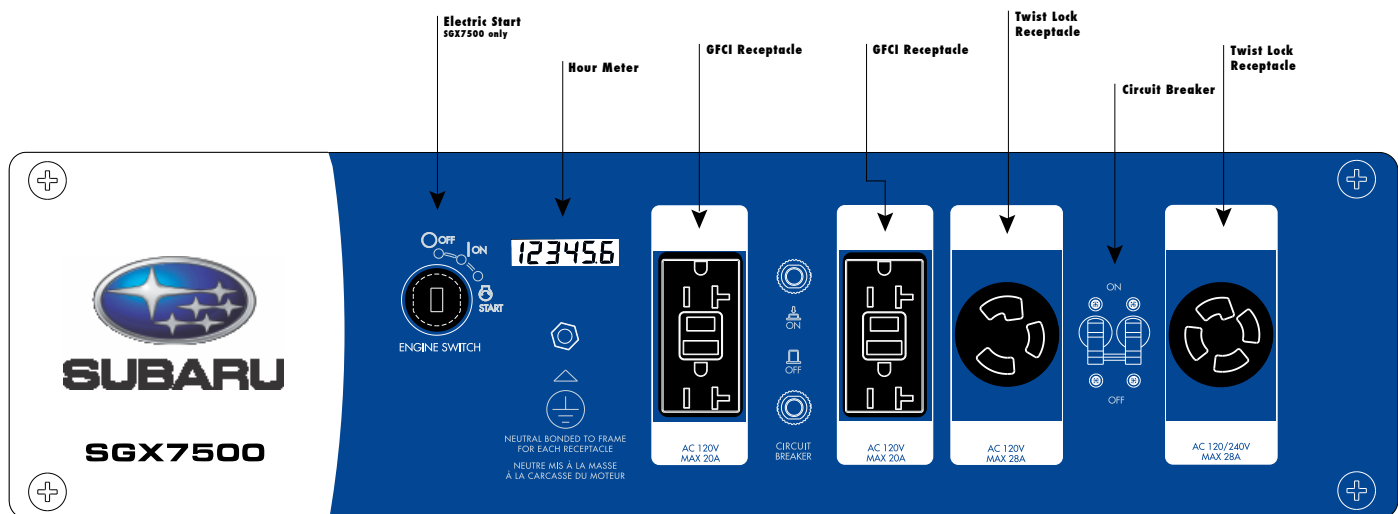

## SGX Series Features & Benefits

Whether it's an ice storm, blackout or just the everyday worksite, Subaru's SGX generators will keep the power flowing when you need it most. Featuring steel tubular wraparound frames, Subaru's technologically-advanced EX series engines, and a long list of outstanding features, these generators are built to withstand the toughest conditions.



### Technologically-Advanced Overhead Cam (OHC) Engines

Offer quieter operation, easier starting and increased longevity. All models come standard with low oil shut-down.



### Flat Free Wheel Kit

Tires will never go flat. Provides enhanced portability and convenience with fold-down handles *(Standard on all models)*



# 3500-7500W

SGX3500 | SGX5000 | SGX7500



## AVR (Automatic Voltage Regulator)

Provides precise voltage control output on the generator, making the system appropriate for sensitive electronic equipment.



## Large Capacity Fuel Tank with Fuel Gauge

Extends run time between refueling and lets the operator know current fuel level.



**Extra-Quiet Tonal Quality Muffler** Also standard with U.S. Forestry-Approved spark arrestor. Reduces the risk of spark-induced fires.



**100% Copper Windings** Ensure high-performance with maximum surge capacity.

# Generator Specifications



Class				
Inverter Silent				
GENERATOR	Model	S3200i	S4300i	
	Emission Compliance	50 State	50 State	
	CSA (Canadian Standards Association) Certified to meet electrical safety standards.	N/A	N/A	
	Type	Inverter		
	Voltage Regulation	Inverter Type		
	Frequency	60 Hz/Single Phase		
	Voltage	120V		
	Max. Output (watts)	3200W	4300W	
	Max. Amps	26.7A	35.8A	
	Rated Output (watts)	2800W	3800W	
	Rated Amps	23.3A	31.7A	
	dbA Rating @ Rated Output (7 meters)	58dbA	62dbA	
ENGINE	Current Protection	Electronic Circuit Breaker & GFCI		
	Model	EX21, 7hp	EX27, 9hp	
	Type	Subaru OHC		
	Low Oil System	Low Oil Shutdown		
	Fuel Tank Capacity	2.9 gal.	3.4 gal.	
	Continuous Operation (hours at rated load)	6.5 hrs.	5.3 hrs.	
	Starting System**	Electric Start (Recoil Back-up)		
RECEPTACLES	Battery Recommendation (or equal)	Interstate CYTX7L-BS	Interstate IB12AL-A	
	Dimensions (L x W x H)	22" x 19" x 23"	23" x 21" x 25"	
	Dry Wt. (Recoil/Electric)	130 lbs.	163 lbs.	
	GFCI 120V, 20A Duplex	1	1	
	120V, 30A Twist Lock	•	•	
	120/240V, 30A Twist Lock			
	120/240V, 50A Twist Lock			
	120V/208V, 30A Twist Lock			
Control Panel	12V DC Charging	•	•	
	Meters	Multi-Monitor w/LED Display - Voltmeter, Hour Meter, Frequency & Overload Condition		
	Idle Control	Auto-Power System		
	Full Power Switch	N/A	N/A	
	Wheel Kit	4-Wheel Standard		

Always read the owner's manual before use. | Specifications subject to change without notice.





## Industrial Power

RGX2900		RGX3600	
	50 State		50 State
	N/A		N/A
Brushless, Self-Excited			
Capacitor Type			
60 Hz/Single Phase			
	120V		120/240V
	2900W		3600W
	24.2A		30/15A
	2400W		3000W
	20A		25/12.5A
	68dbA		71dbA
Fuseless Circuit Breaker and GFCI			
	EX17, 6hp		EX21, 7hp
Subaru OHC			
Low Oil Shutdown			
	4.4 gal.		4.4 gal.
	10.5 hrs.		8.4 hrs.
Recoil			
	N/A		N/A
	23" x 17" x 22"		24" x 18" x 23"
	106 lbs.		119 lbs.
	1		1
			•
			•
	•		•
Hour Meter			
			•
			•
Optional 2-Wheel			

**\*\*Battery not included on electric models.**

# Generator Specifications



Class				
Industrial Power				
GENERATOR	Model		RGX4800/RGX4800E	RGX6500/RGX6500E
	Emission Compliance		50 State	50 State
	CSA (Canadian Standards Association) Certified to meet electrical safety standards.		N/A	N/A
	Type		Brushless	Brush-Type
	Voltage Regulation		Capacitor	AVR Type
	AC Output	Frequency	60 Hz/Single Phase	
		Voltage	120/240V	
		Max. Output (watts)	4800W	6500W
		Max. Amps	40/20A	54.2/27.1A
		Rated Output (watts)	4100W	5000W
		Rated Amps	34.2/17.1A	41.7/20.8A
		dbA Rating @ Rated Output (7 meters)	72dbA	75dbA
	Current Protection		Fuseless Circuit Breaker and GFCI	
ENGINE	Model		EX27, 9hp	EX35, 12hp
	Type		Subaru OHC	
	Low Oil System		Low Oil Shutdown	
	Fuel Tank Capacity		4.4 gal.	7.3 gal.
	Continuous Operation (hours at rated load)		6 hrs.	8.3 hrs.
	Starting System**		Recoil or Electric with Recoil Back-up	
	Battery Recommendation (or equal)		Interstate SP40	
RECEPTACLES	Dimensions (L x W x H)		26" x 21" x 24" 32" x 21" x 24"	28" x 22" x 24" 35" x 22" x 24"
	Dry Wt. (Recoil/Electric)		154/172 lbs.	187/207 lbs.
	GFCI 120V, 20A Duplex		1	2
	120V, 30A Twist Lock		•	•
	120/240V, 30A Twist Lock		•	•
	120/240V, 50A Twist Lock			
	120V/208V, 30A Twist Lock			
	12V DC Charging		•	•
	Control Panel	Meters	Hour Meter	
		Idle Control	•	•
		Full Power Switch	•	•
	Wheel Kit		Optional 2-Wheel	

Always read the owner's manual before use. | Specifications subject to change without notice. | \*\*Battery not included on electric models.





## Industrial Power

RGX7500/RGX7500E		RGV12100		RGV13100T	
	50 State	50 State		50 State	
	N/A	N/A		N/A	
	Brush-Type	Brush-Type Self-Excited			
	AVR Type			Current Transformer	
	60 Hz/Single Phase			60 Hz/1 & 3 Phase	
	120/240V			120/208V	
	7500W	12,000W		13,000W	
	62.5/31.5A	100/50A		***	
	6000W	9500W		10,000W	
	50/25A	79.2/39.6A		***	
	76dbA	77dbA		77dbA	
	Fuseless Circuit Breaker and GFCI				
	EX40, 14hp	EH65, 22hp		EH64, 20.5hp	
	Subaru OHC	Subaru V-Twin			
	Low Oil Shutdown	Low Pressure			
	7.3 gal.	11.4 gal.		11.4 gal.	
	8.3 hrs.	8.2 hrs.		8.9 hrs.	
	Recoil or Electric with Recoil Back-up	Electric			
	Interstate SP40				
	28" x 22" x 24" 35" x 22" x 24"	33" x 30" x 34"		51" x 34" x 37"*	
	193/215 lbs.	329 lbs.		315 lbs.	
	2	2		1	
	•	•		•	
	•	•			
		•			
				•	
	•				
	Hour Meter	Voltmeter & Hour Meter			
	•	•			
	•				
	Optional 2-Wheel	4-Wheel Standard/ 2-Wheel Optional		2-Wheel Standard	

\*Less wheel kit dimensions: 33" X 24" X 28" • \*\*\*RGV13100T amps • 120V Single Phase = 28 amps/leg • 3 Phase = 34.6 amps total

# Generator Specifications



		Model	SGX3500	SGX5000
GENERATOR		Emission Compliancy	50 State	50 State
		CSA (Canadian Standards Association) Certified to meet electrical safety standards.	Standard	
		Type	Brush-Type	
		Voltage Regulation	AVR Type	
	AC Output	Frequency	60 Hz/Single Phase	
		Voltage	120/240V	
		Max. Output (watts)	3500W	4900W
		Max. Amps	29.2/14.6A	40.8/20.4A
		Rated Output (watts)	3200W	4500W
		Rated Amps	26.6/13.3A	37.5/18.8A
		dbA Rating @ Rated Output (7 meters)	72dbA	76dbA
		Current Protection	Dual Pole Magnetic Circuit Breaker & GFCI	
ENGINE		Model	EX21, 7hp	EX30, 9.5hp
		Type	Subaru OHC	
		Low Oil System	Low Oil Shutdown	
		Fuel Tank Capacity	4 gal.	8 gal.
		Continuous Operation (Hours at Rated Load)	8 hrs.	10.7 hrs.
		Starting System**	Recoil	
RECEPTACLES		Battery Recommendation (or equal)	N/A	N/A
		Dimensions (L x W x H)	28" x 25" x 26"	30" x 29" x 29"
		Dimensions (L x W x H Less Wheel Kit)	24" x 17" x 21"	28" x 21" x 24"
		Dry Wt. (Recoil/Electric)	137 lbs.	177 lbs.
		GFCI 120V, 20A Duplex	2	2
		120V, 30A Twist Lock	N/A	1
		120/240V, 30A Twist Lock	1	1
Control Panel		120/240V, 50A Twist Lock	N/A	N/A
		120V/208V, 30A Twist Lock	N/A	N/A
		12V DC Charging	N/A	N/A
		Meters	Hour Meter	
		Idle Control	N/A	N/A
		Full Power Switch	N/A	N/A
		Wheel Kit	2-Wheel Standard	



# Generator Accessories



**SGX7500E**

	50 State
	Standard
	Brush-Type
	AVR Type
	60 Hz/Single Phase
	120/240V
	7300W
	60.8/30.4A
	6700W
	55.8/27.9A
	76dbA
	Dual Pole Magnetic Thermal Circuit Breaker & GFCI
	EX40, 14hp
	Subaru OHC
	Low Oil Shutdown
	8 gal.
	7 hrs.
	Electric with Recoil Back-up
	12V .18 AH (nut & bolt type) Interstate BSL-1116*
	30" x 29" x 29"
	28" x 21" x 24"
	229 lbs.
	2
	1
	1
	N/A
	N/A
	N/A
	Hour Meter
	N/A
	N/A
	2-Wheel Standard

Subaru offers a full line of accessories to complement every generator. Some accessories are standard on select models, while some are only available on certain models.



- ① **Twist Lock Plugs**  
Ensure a safe and reliable connection – various sizes of both male and female plugs are available.
- ② **Remote Control**  
Adds flexibility and convenience by allowing remote start/stop operation – offered on the RGV12100.
- ③ **Spider Adaptor**  
Converts a 30-amp Twist Lock receptacle to three household receptacles.
- ④ **Battery Charging Cables**  
Provide convenient battery charging – available on inverter models, RGX2900 through RGX7500E.
- ⑤ **RV Adaptor**  
Allows a generator with a L5-30 locking plug receptacle to be connected to recreational vehicles that use a typical RV extension cord.
- ⑥ **Lifting Eye**  
Balances the unit for safe, easy loading and unloading.
- ⑦ **Wheel Kit**  
Enhances portability – standard on all SGX models, optional on all RGX and RGV12100 models.
- ⑧ **Generator Cover**  
Protects the generator when not in use. Available for all models.

\*Battery included - Battery replacement recommendation.



905 Telser Road  
Lake Zurich, IL 60047, USA  
tel: 847-540-7300 | toll free: 800-277-6246  
email: [sales@subarupower.com](mailto:sales@subarupower.com)  
web: [www.subarupower.com](http://www.subarupower.com)

Using an engine indoors can kill you in minutes!  
Engine exhaust contains carbon monoxide. This is a  
poison you cannot see or smell. Never use inside a home  
or garage, even if doors and windows are open. Only use  
outside and far away from windows, doors and vents.